

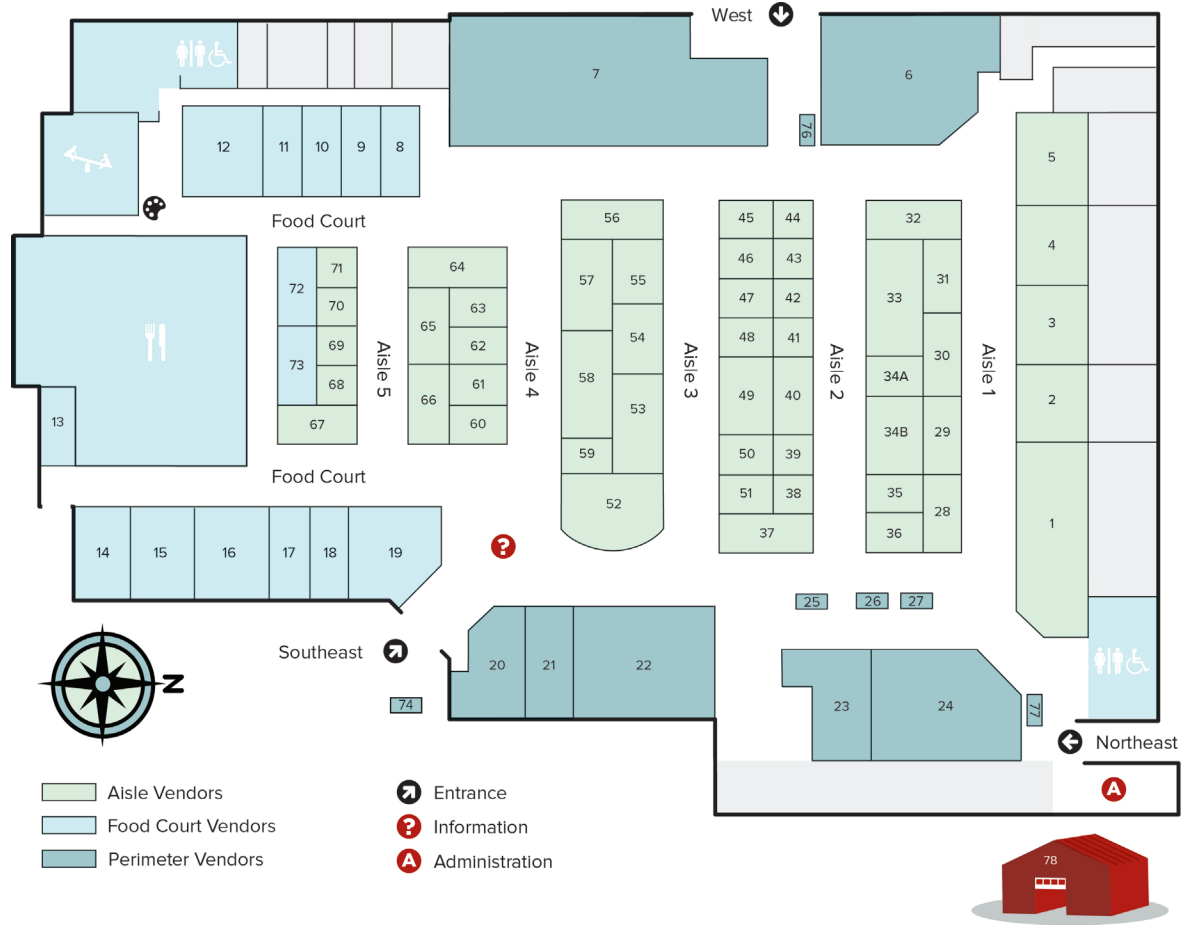

Market Vendors

Aisle (A)
Food Court (FC)
Perimeter (P)
Booth #

**Vendor locations may change, please visit Customer Service for up-to-date info.*



- | | | |
|---|--|---|
| FC 12 2 Greek Gals | A3 56 Going Nuts | A1 1 Panorama Orchards |
| P 76 Artistically Inclined By: Louise Kollmel | A3 54 Good For You Snacks | A2 41 Scoop |
| A4 57 A Taste of Quebec | A4 58 Gull Valley Greenhouses | FC 8 Shanghai Fine Food |
| A3 45 Bauer Meats | A2 39/40 Hearts Choices | FC 14 Shef's Fiery Kitchen |
| A1 32 Beeland | FC 73 Henry & Debbie's Coffee and Goodies | A2 35 Silk Road Spice Merchant |
| A4 64 Better. | P 22 Innisfail Growers Co-op | A1 5 Silver Sage Beef |
| P 23 Big T's Smokehouse | A1 31 Jarred | FC 11 Silver Sage Grill |
| P 6 Blush Lane Organic Market | A5 71 Jelly Modern Doughnuts | P 24 Simple Simon Pies/Meals |
| A2 44 Bon A-Pet-Treat! Pet Store and Bakery | A5 68 Kin Sushi | FC 15 Simply Good Eats |
| FC 9 Cachito Gourmet | FC 18 Knead Pizza | A3 48/49 Soffrito's Oil and Vinegar |
| A5 66 Chef's Earth Inc. | A3 50 Knifewear | A1 28 Spragg's Meat Shop |
| P 7 Cherry Pit | A5 67 Ma Bonne Crêpe | P 21 Stillwater Design |
| A3 46 CHOPD | A5 69/70 Le's Homemade Vietnamese | FC 19 Stock and Sauce Co. |
| A4 62/63 Crafted | FC 17 Los Chilitos Taqueria | P 74 Sugar Creek Kettle Corn |
| P 25 Cribbage Works | A2 33 Luc's European Meats, Cheese & Eats | A1 2 Sylvan Star Cheese |
| P 26 D'Alpaca Peru | A2 34B Lunds's Organic | A3 51 Terra Farms / Berit Havre Designs (seasonal) |
| A4 59 Delissitude | A5 65 Major Spud & the Kernel | A2 37 The Tomato Man |
| FC 13 Eats of Asia | FC 16 Margarita's Dishes | A3 36 TotaliTea - The Tea Boutique |
| A2 38 Eau Claire Distillery | A2 34A Margarita's To Go | A1 29 Twin Creek Colony / Pasu Farms (seasonal) |
| A4 61 Eco Store by Sun Country | A1 4 Market Seafood & Specialty Meats | P 77 Ursula A. Krol Photography |
| A3 53 Eden Essentials | A3 55 Master Chocolat | A4 60 Wayne's Bagels |
| A3 47 Field Stone Fruit Wines | A1 30 Missing Link Extraordinary Sausage | FC 10 Yoon's Chicken |
| P 20 Flowers at the Market | A2 42/43 The Nook | A1 3 Yum Bakery |
| FC 72 Frank and Mabel's Gourmet Hot Dogs & Frozen Treats | P 27 Olivewood Glory | Face Painter |
| A3 52 Fratello Analog Coffee | | |

Outdoors / Parking Lot:
78 J.Webb Market Wines